

TREMCO PROTECTION COURSE,  
AS SPECIFIED

TREMPROOF 560A

DYMONIC 100 DETAIL STRIP

TERMINATION BAR NAILED  
EVERY 8" O.C. AND DETAILED  
WITH DYMONIC 100  
(REQUIRED IN SUBMERGED  
CONDITIONS)

SUPERSTOP

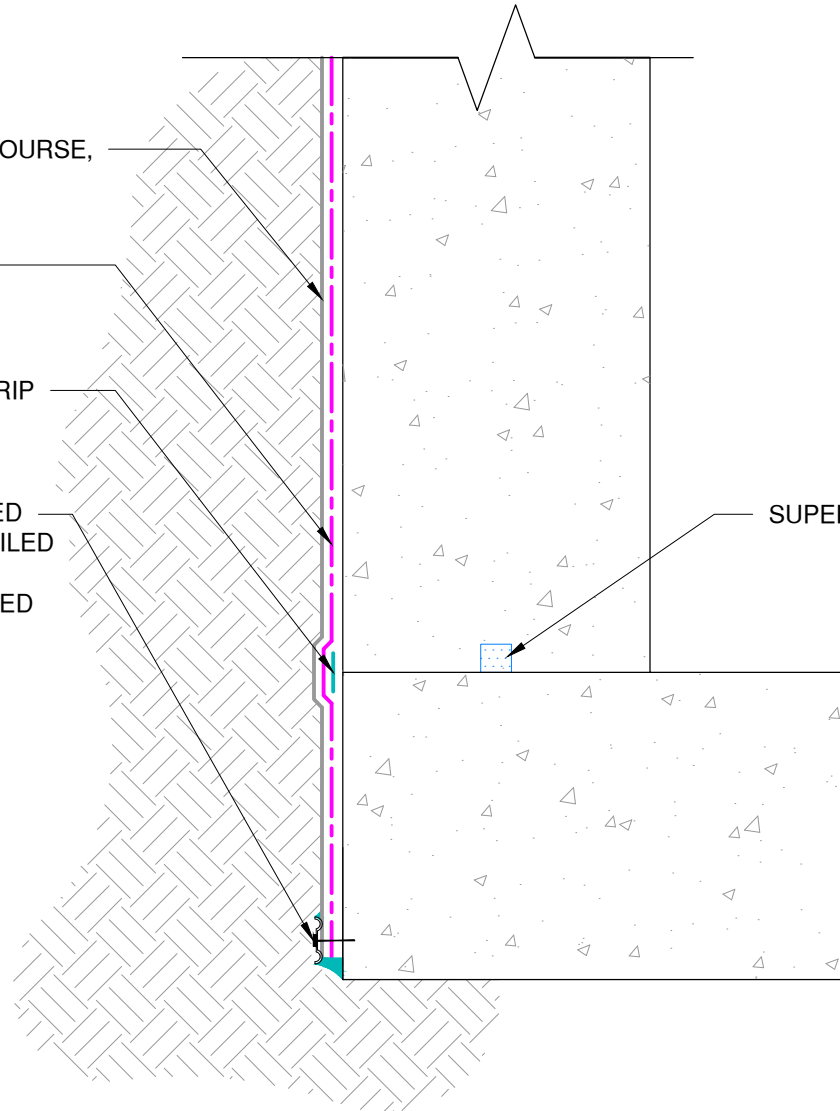

NOTE: TREMPRIME 500 MUST BE APPLIED BEFORE  
THE APPLICATION OF TREMPROOF 560A

*The architecture, engineering, and design of the project using the Tremco products are the responsibility of the project's design professional. All products and systems must comply with local building codes and standards. This detail is for general information and guidance only and Tremco specifically disclaims any liability for the use of this detail. The project design professional determines, in its sole discretion, whether this detail or a functionally equivalent detail is best suited for the project. This detail is subject to change without notice. Contact Tremco to ensure you have the most recent version.*

**TREMProof 560A**



Detail: TREMProof 560A at Flush Footer

File Name:

Drawn by: HDE

Checked by: WH

Scale: NTS

Date: 1/10/2024

**560A-G-05**

Tremco Technical Support: 866-209-2404

[www.tremcocpg.com](http://www.tremcocpg.com)



Construction Products Group