

EXOAIR 110AT OR 110 BELLOUED INTO CONTROL JOINT WITH DETAIL PIECE OF ADHESIVE TO ADHESIVE SIDE OF MEMBRANE.

DESIGN PROFESSIONAL TO DETERMINE SIZE WITH ANTICIPATED MOVEMENT

DYMONIC 100

EXOAIR 220, 230 OR 230LT

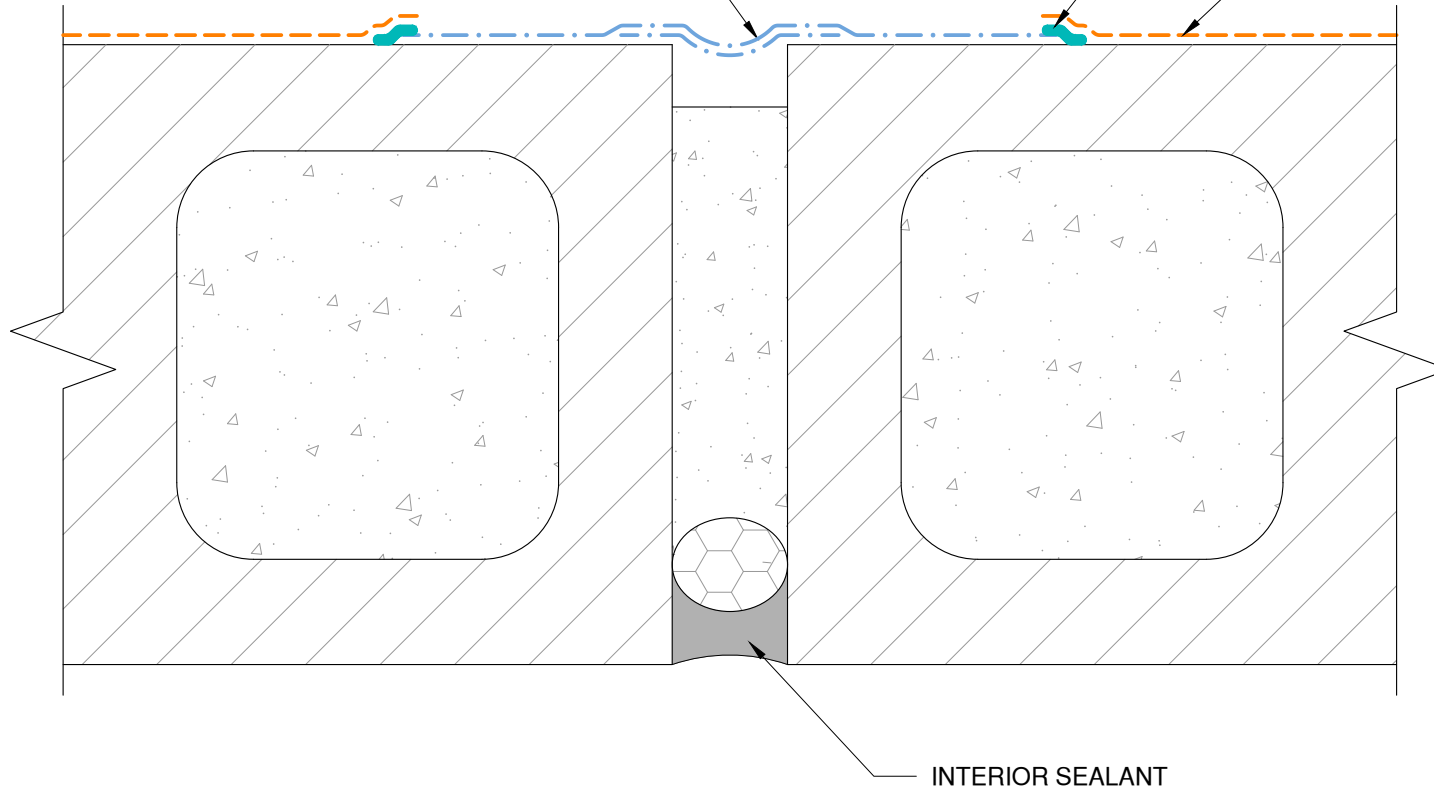

NOTE: JOINT TO BE FILLED AND ROLLED OR DOWEL TO SPAN BUILDING FACADE NOT SHOWN FOR CLARITY  
EXOAIR PRIMER MUST BE USED WITH EXOAIR 110

*The architecture, engineering, and design of the project using the Tremco products are the responsibility of the project's design professional. All products and systems must comply with local building codes and standards. This detail is for general information and guidance only and Tremco specifically disclaims any liability for the use of this detail. The project design professional determines, in its sole discretion, whether this detail or a functionally equivalent detail is best suited for the project. This detail is subject to change without notice. Contact Tremco to ensure you have the most recent version.*

**ExoAir 220/230**



Detail: Permeable Fluid - Control Joint - ExoAir 110AT/110

File Name:

Drawn by: KAB

Checked by: CB

Scale: NTS

Date: 4/13/2023

AVB-CP-F-CJ-01



Construction Products Group

Tremco Technical Support: 866-209-2404

[www.tremcocpg.com](http://www.tremcocpg.com)