

**NOTE:**  
 PARASEAL PRODUCTS REQUIRE A MIN 24 PSF OF  
 COMPACTION/CONFINEMENT IN ORDER TO FUNCTION AS DESIGNED

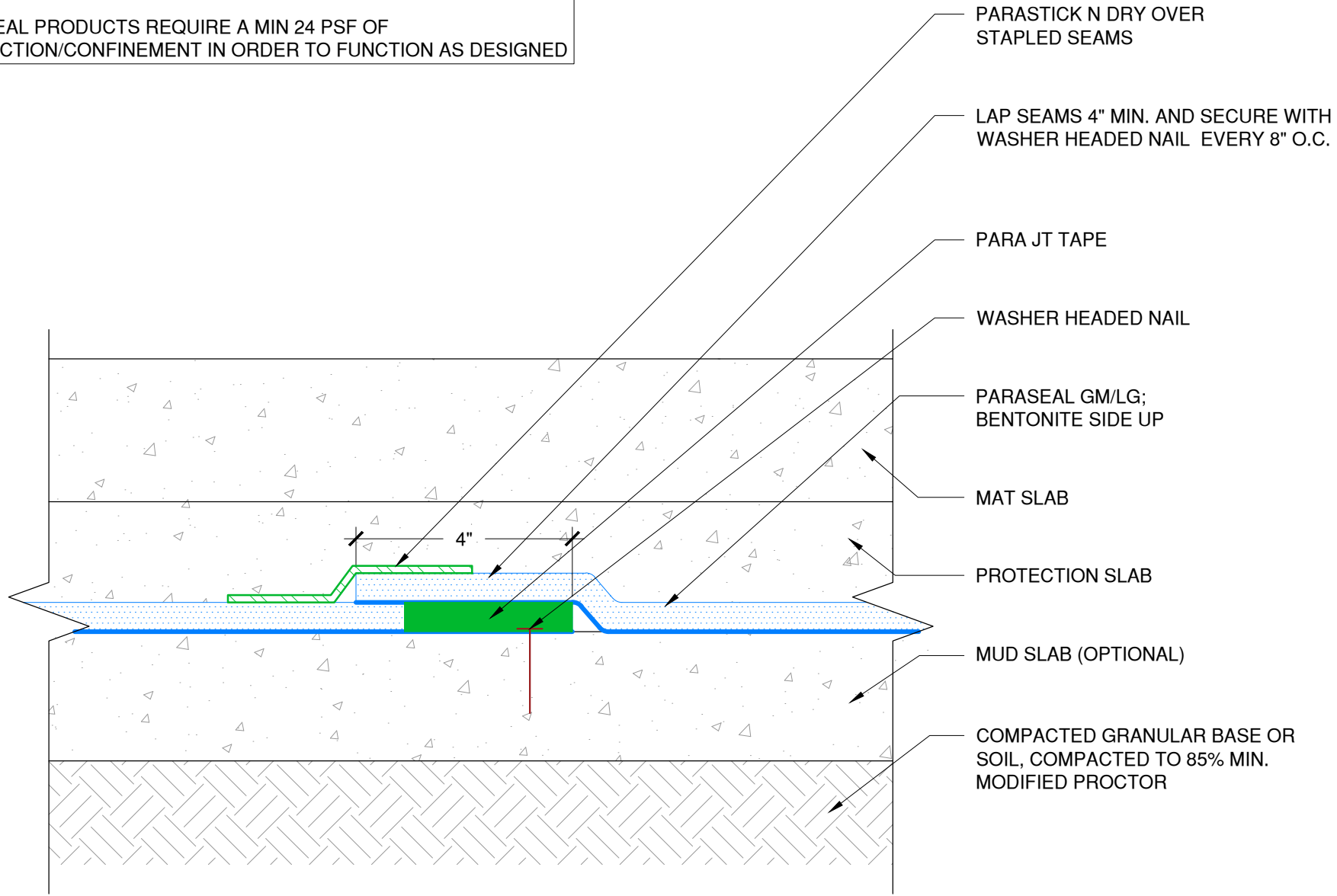

- PARASTICK N DRY OVER STAPLED SEAMS
- LAP SEAMS 4" MIN. AND SECURE WITH WASHER HEADED NAIL EVERY 8" O.C.
- PARA JT TAPE
- WASHER HEADED NAIL
- PARASEAL GM/LG; BENTONITE SIDE UP
- MAT SLAB
- PROTECTION SLAB
- MUD SLAB (OPTIONAL)
- COMPACTED GRANULAR BASE OR SOIL, COMPACTED TO 85% MIN. MODIFIED PROCTOR

The architecture, engineering, and design of the project using the Tremco products are the responsibility of the project's design professional. All products and systems must comply with local building codes and standards. This detail is for general information and guidance only and Tremco specifically disclaims any liability for the use of this detail. The project design professional determines, in its sole discretion, whether this detail or a functionally equivalent detail is best suited for the project. This detail is subject to change without notice. Contact Tremco to ensure you have the most recent version.

**Paraseal GM/LG 20 Mil Below Slab on Grade - HDPE Side Down**



Detail: Paraseal GM/LG 20 Mil Below Slab on Grade Seam

|               |                |            |                 |
|---------------|----------------|------------|-----------------|
| Drawn by: HDE | Checked by: WH | Scale: NTS | Date: 8/31/2022 |
|---------------|----------------|------------|-----------------|

www.tremcocpg.com

File Name:  
**BSOG-GM20-S-02**

