

VULKEM 346 OR 951NF
TOP COAT

VULKEM 346, 950NF 951NF OR
VULKEM EPOXY WC
INTERMEDIATE COAT W/AGGREGATE

VULKEM 350NF OR 360NF
BASE COAT

TREMCO PUMA TC*

TREMCO PUMA WC*, SEEDED TO
REFUSAL WITH AGGREGATE

TREMCO PUMA BC*

TREMCO PUMA PRIMER*

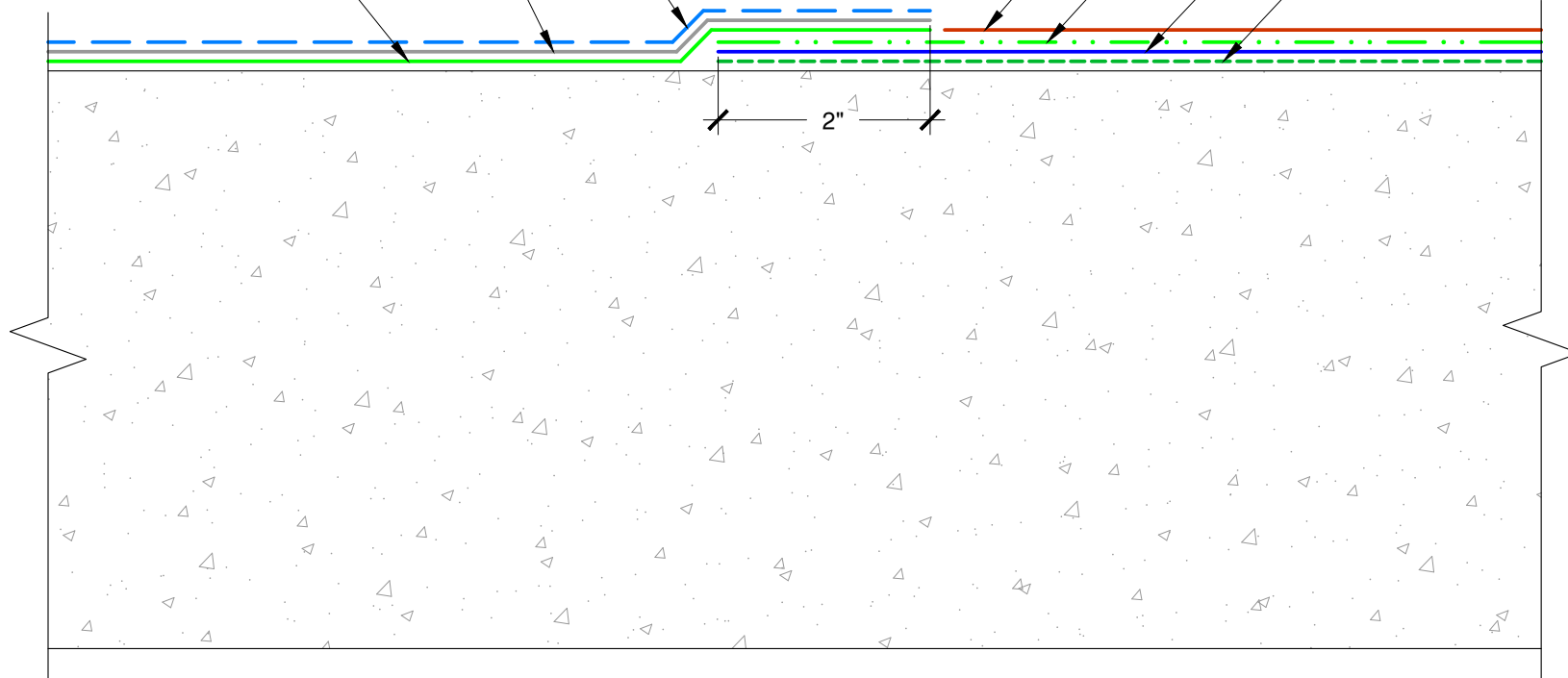

NOTE: VULKEM 950 NF MAY BE USED AS TOPCOAT IN AREAS WITH NO U.V.

The architecture, engineering, and design of the project using the Tremco products are the responsibility of the project's design professional. All products and systems must comply with local building codes and standards. This detail is for general information and guidance only and Tremco specifically disclaims any liability for the use of this detail. The project design professional determines, in its sole discretion, whether this detail or a functionally equivalent detail is best suited for the project. This detail is subject to change without notice. Contact Tremco to ensure you have the most recent version.

Vulkem Vehicular Coating



Tremco Technical Support: 866-209-2404

Detail: Vulkem Vehicular System to Vulkem EWS System

Drawn by: KAB

Checked by: EL

Scale: NTS

Date: 1/18/2023

File Name:

DC-V-T-02



Construction Products Group

www.tremcocpg.com