

EXOAIR 130/230

EXOAIR DUALFLASH

ENGINEERED FRAMING SYSTEM
BY PREBUCK LLC
OR FUNCTIONAL EQUIVALENT

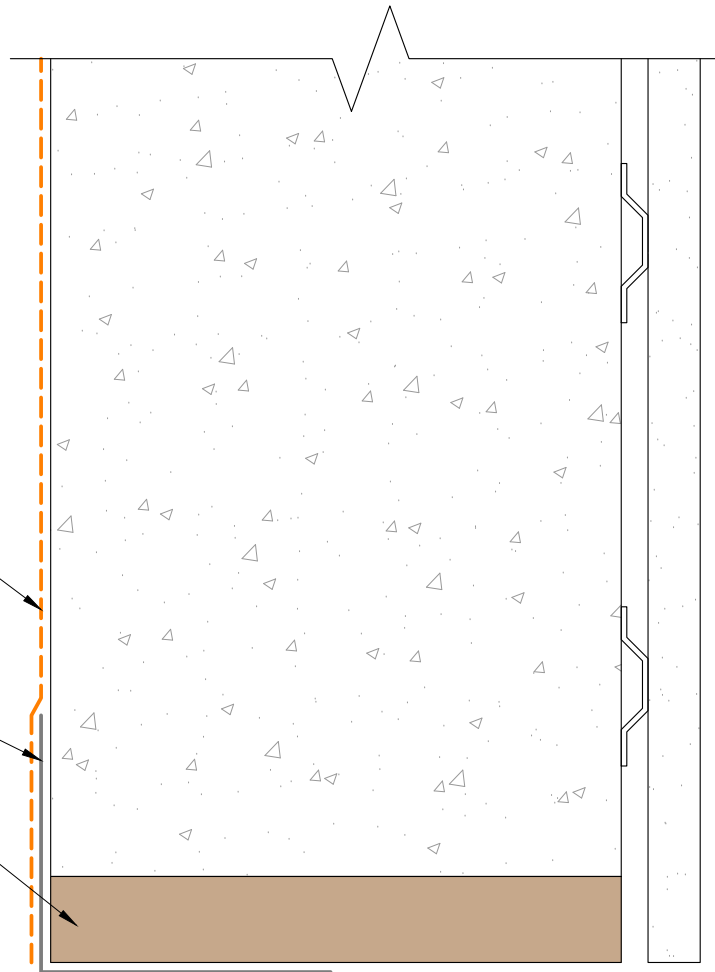

NOTES: WINDOW AND BUILDING FACADE NOT SHOWN FOR CLARITY

This detail is for general informational purposes only. The project design professional determines, in its sole discretion, whether this detail or a functionally equivalent detail is best suited for the project with respect to any architecture, engineering, and design requirements, including any local building code requirements. If this document is not reviewed and the product is not approved for use by a licensed design professional, the customer agrees that the detail may contain substantive flaws requiring correction, and hereby releases Tremco CPG Inc. from any and all liability related to the design and installation of the product. This detail is subject to change without notice. Contact Tremco to ensure you have the most recent version.

ExoAir DualFlash



Tremco Technical Support: 866-209-2404

Detail: Head

Drawn by: HDE

Revision #: 01

Checked by: CB

Revised by: KAB

Scale: NTS

Date: 11/19/2024

File Name:

DF-WH-01



Construction Products Group

www.tremcocpg.com