

LIQUID-APPLIED REINFORCED FLASHING (EXTENDED DOWN VERTICAL FACE)

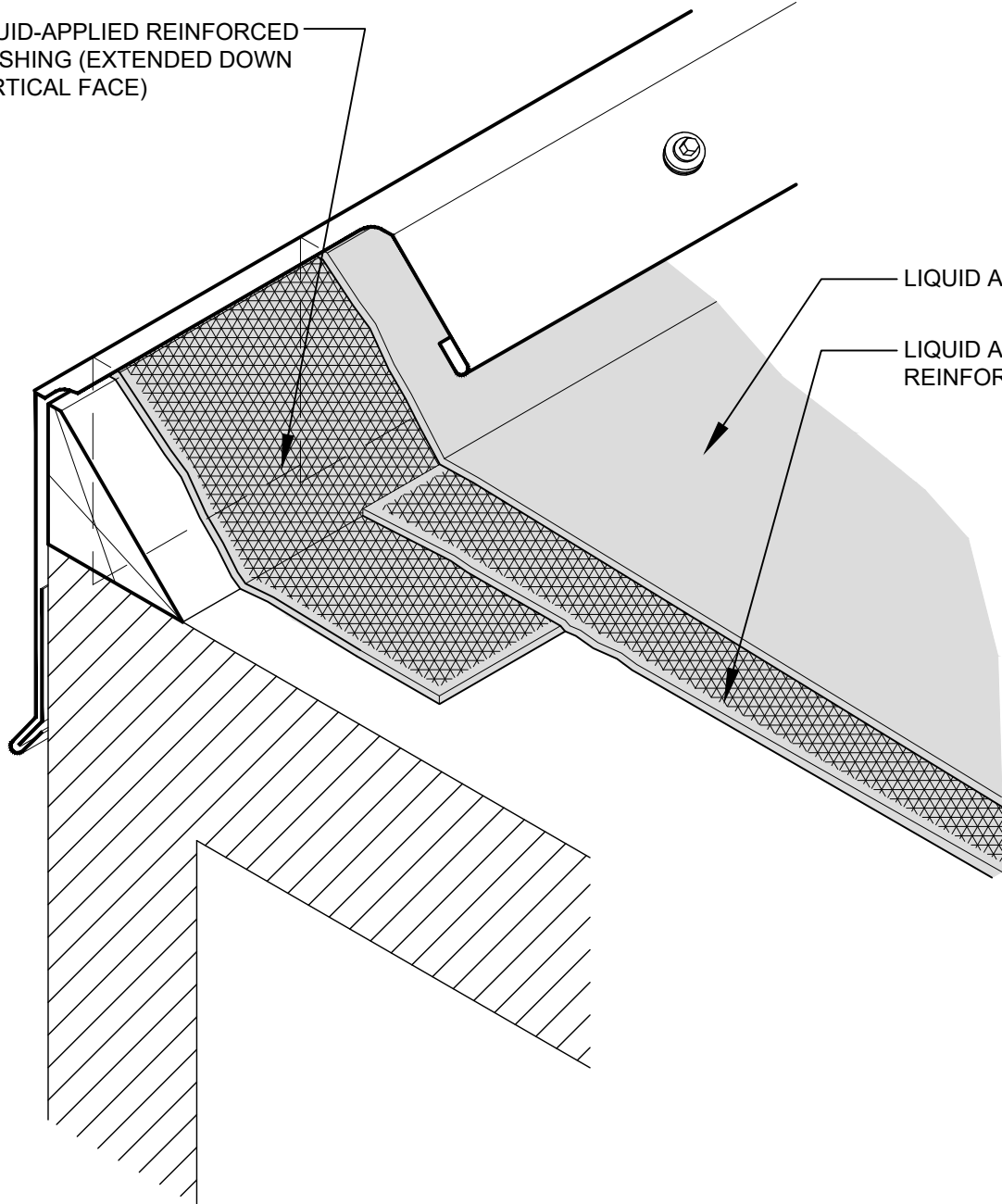

LIQUID APPLIED TOP COAT

LIQUID APPLIED REINFORCED BASE COAT

NOTES

1. PRIMING OF THE SUBSTRATE MAY BE REQUIRED. FOLLOW SPECIFICATIONS AND MANUFACTURER'S RECOMMENDATIONS.



SHEET TITLE:
RAISED PERIMETER EDGE
WITH METAL FLASHING FULLY
REINFORCED OVER CONCRETE

SCALE:
NTS

DRAWING No.:
DWG NO. LA-CFR-02