

*A COMPONENT OF THE VULKEM® EWS TRAFFIC COATING SYSTEM WITH PUMA (POLYURETHANE METHACRYLATE)

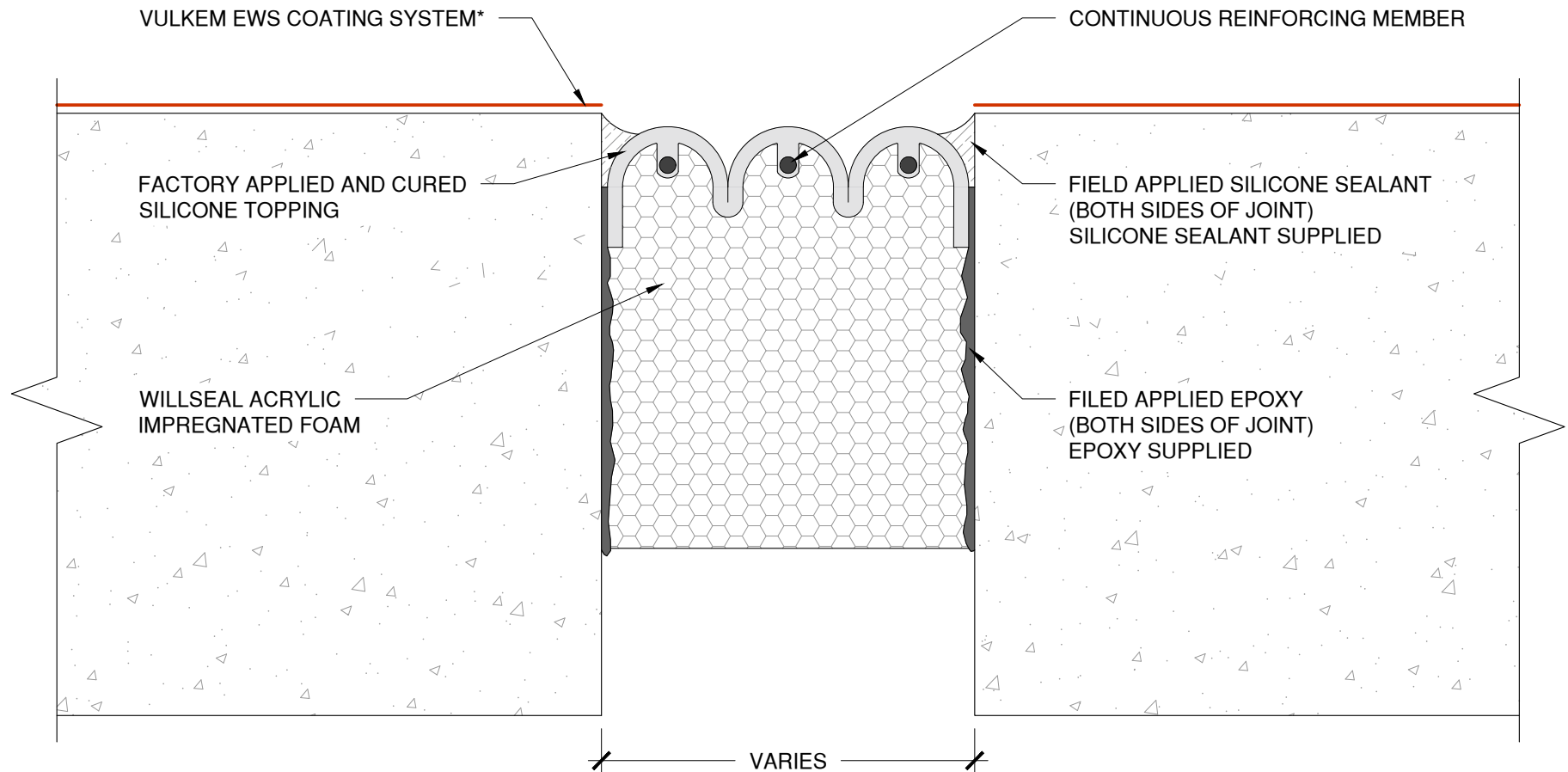

NOTE: REFER TO TREMCO'S PUBLISHED APPLICATION INSTRUCTIONS FOR ACCEPTABLE JOINT SIDE WALL SUBSTRATE CONDITIONS PRIOR TO INSTALLATION

The architecture, engineering, and design of the project using the Tremco and Willseal products are the responsibility of the project's design professional. All products and systems must comply with local building codes and standards. This detail is for general information and guidance only and Tremco and Willseal specifically disclaims any liability for the use of this detail. The project design professional determines, in its sole discretion, whether this detail or a functionally equivalent detail is best suited for the project. This detail is subject to change without notice. Contact Willseal or Tremco to ensure you have the most recent version.

Willseal 250-R



Willseal Technical Support: 800-274-2813

Detail: Willseal 250-R with Vulkem EWS System at Floor to Floor Expansion Joint

Drawn by: HDE

Checked by: AM/EL

Scale: NTS

Date: 4/25/2022

File Name:

W250R-FF-EWS-01



Construction Products Group

www.tremcocpg.com